

### Fixed Magnification Lens 110mm(W.D.) 1/2" Format

### Item No.05-110

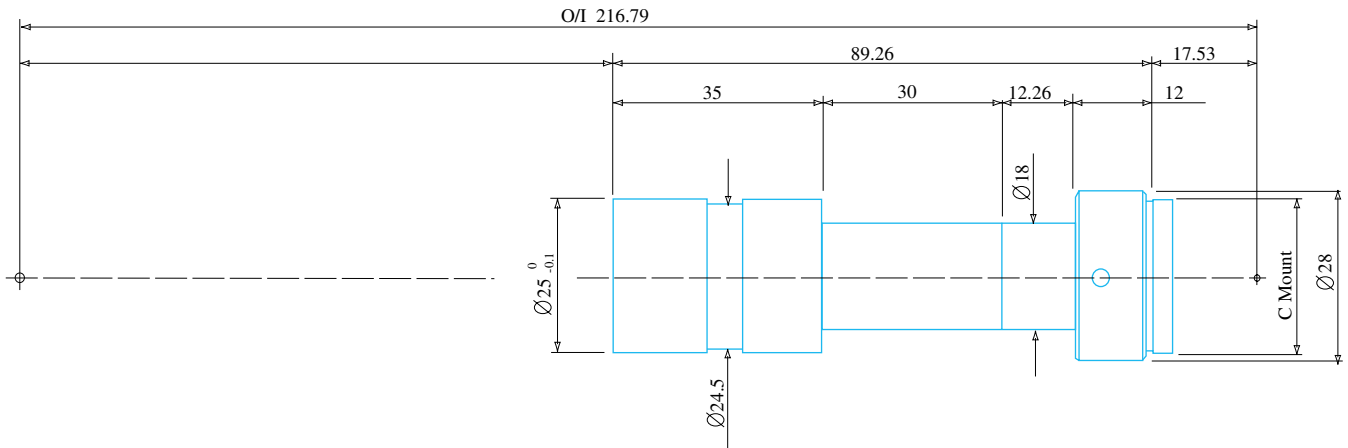

ITEM NO.		1-110	
MAGNIFICATION		x1.00	
W.D.		110	(mm)
APERTURE		1.3	
DEPTH OF FIELD		6.6 x 8.8	(mm)
OBJECT SIZE		6.6 x 8.8	(mm)
IMAGE SIZE		14	(mm)
RESOLUTION POWER		0.025	( $\mu$ m)
NA		0.03	(%)
TV DISTORTION		-	(%)
FIELD OF VIEW	1/2"	4.8 x 6.4	(mm)
	1/3"	3.6 x 4.8	(mm)
	1/4"	2.7 x 3.6	(mm)
NOTES		Straight	

### **GOYO OPTICAL Inc.**

#### **Japanese Office**

3-8-31 HAMAZAKI,  
ASAKA,  
SAITAMA 351-0033,  
JAPAN,  
TEL:048-474-2235  
FAX:048-474-7373  
E-MAIL:info@goyooptical.com

#### **German Office**

KURHAUSSTR,3  
ROOM N°19  
D-55543 BAD KREUZNACH  
GERMANY  
TEL:0671-4822255  
FAX:0671-43603  
E-MAIL:info@goyooptical.com